



NEW!
**contecline
compact**

efficient

sustainable

effective

NEW: contecline compact

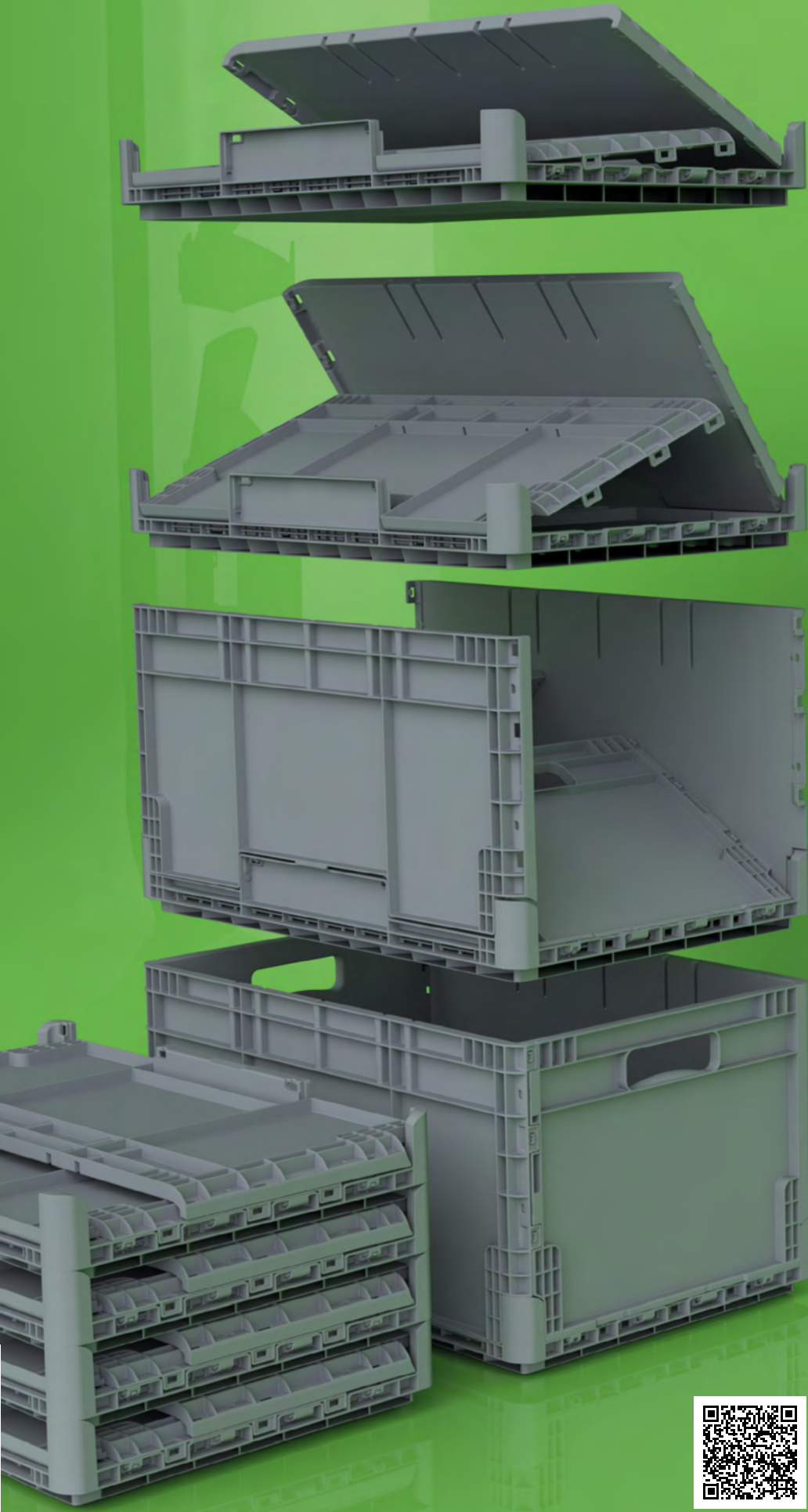

Efficient, sustainable,
effective

contecline compact

The **contecline compact** combines the constructive advantages of a classic intralogistics container with the logistical advantages of a collapsible container.

The volume in the compacted state is 70 % smaller in order to save space when storing and transporting the containers. For use in the automated small parts warehouse, the compacted container is raised once fully automatically. After raising, the side walls of the **contecline compact** are securely fixed and the container is ready for use in intralogistics.

Fire-protected

contecline compact complies with the international fire protection regulations of FM Global and VdS.



The advantages in overview

✓ **Efficient**

The compacted containers have a 70 % volume reduction compared to the rigid version. This allows to store and transport the containers in a space-saving way and subsequently to reduce transport and storage costs.

✓ **Sustainable**

Only 1/3 of truck transports are required, thus significant reducing CO₂ and climate damaging emissions.

✓ **High performance**

The containers will be raised fully automatically one time and the side walls will be fixed in its position. The running properties and stability of the **contecline compact** are identical to the rigid contecline version.





bekuplast GmbH · Industriestraße 1 · 49824 Ringe · Germany
T +49 5944 9333-0 · info@bekuplast.com · www.bekuplast.com